

FACILITY MAPS

BLUFFTON REGIONAL MEDICAL CENTER

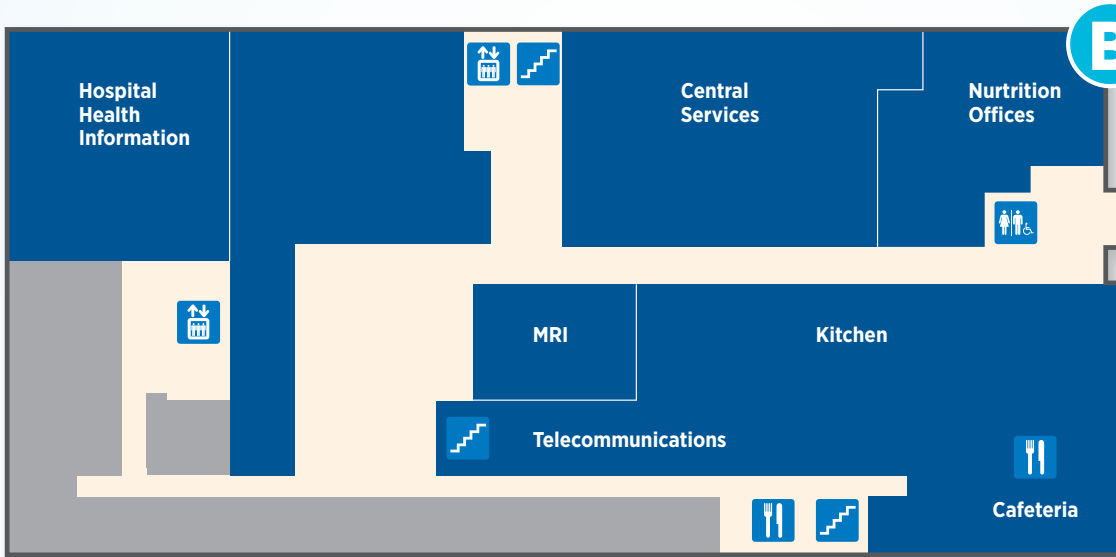

B

BASEMENT

- Cafeteria
- Central Services
- Hospital Health Information
- MRI
- Telecommunications

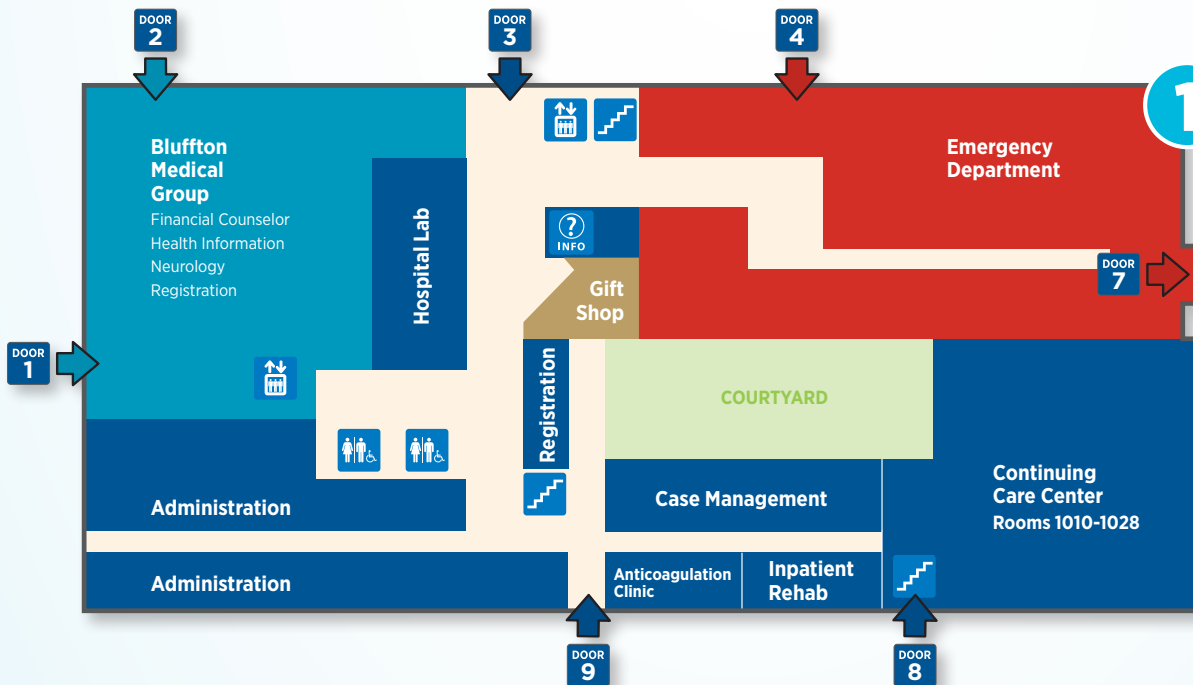

1

FIRST FLOOR

- Administration
- Bluffton Medical Group
 - Financial Counselor
 - Health Information
 - Neurology
 - Registration
- Case Management
- Continuing Care Center
- Anticoagulation Clinic
- Emergency
- Gift Shop
- Hospital Laboratory
- Inpatient Rehabilitation
- Registration

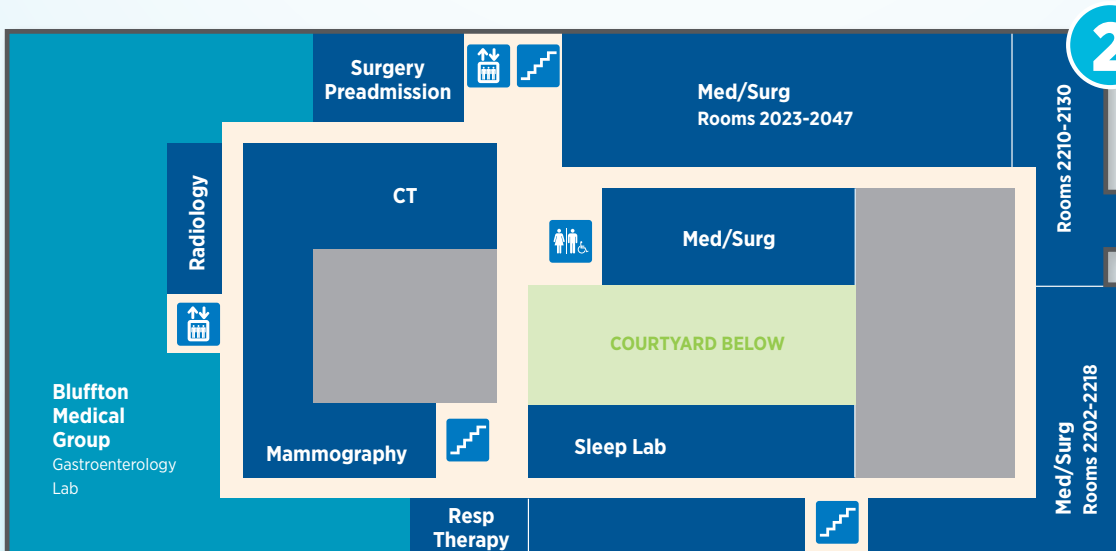

2

SECOND FLOOR

- Bluffton Medical Group
 - Gastroenterology
 - Laboratory
- Mammography
- Medical/Surgical
- Radiology
- Respiratory Therapy
- Sleep Laboratory
- Surgery Preadmission

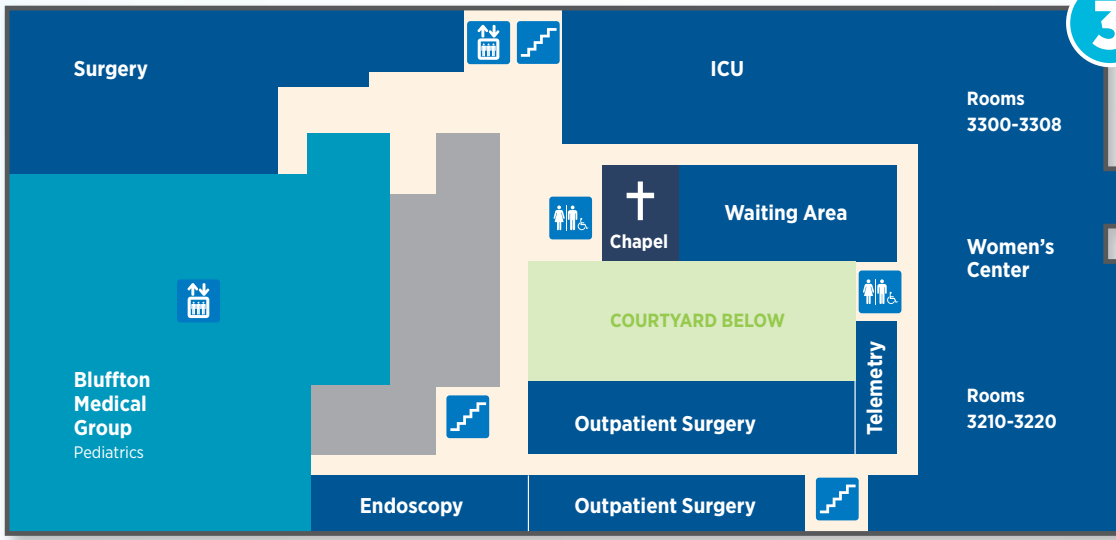

3 THIRD FLOOR

- Bluffton Medical Group
 - Pediatrics
- Chapel
- Endoscopy
- ICU
- Outpatient Surgery
- Surgery
- Waiting Area
- Women's Center

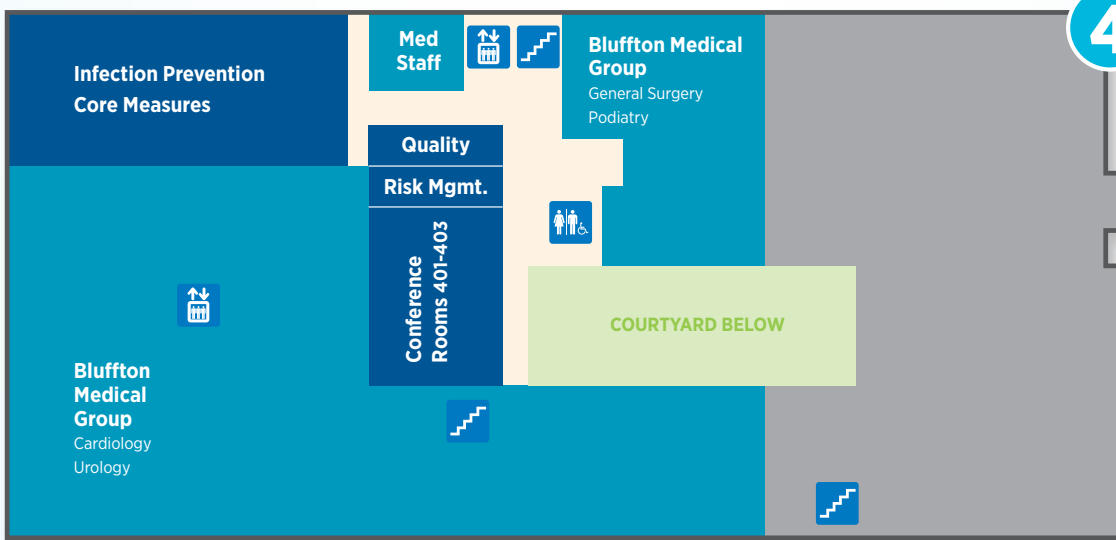

4 FOURTH FLOOR

- Bluffton Medical Group
 - Cardiology
 - General Surgery
 - Podiatry
 - Urology
- Conference Rooms
- Infection Prevention/ Core Measures
- Medical Staff Office
- Quality
- Risk Management



5 FIFTH FLOOR

- Bluffton Medical Group
 - Internal Medicine
 - Pulmonology

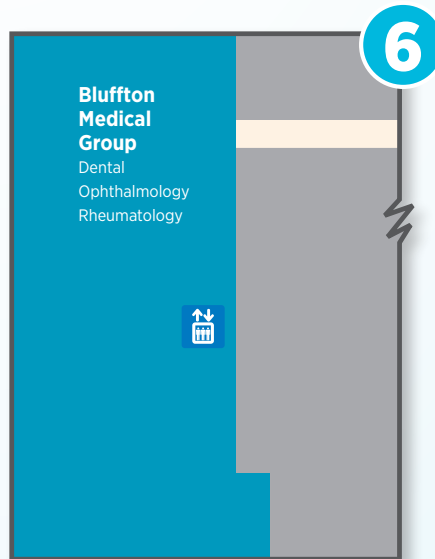

6 SIXTH FLOOR

- Bluffton Medical Group
 - Dental
 - Ophthalmology
 - Rheumatology

MAP KEY:



Information



Elevators



Stairs



Cafeteria



Restrooms

FOR MORE INFORMATION:

(260) 824-3210

303 S. Main St. | Bluffton, IN 46714
LutheranHealth.net/Bluffton



Lutheran Health Network

Bluffton Regional Medical Center